

How to find the zoning of your property

Step 1 – Access the Sechelt Explorer Map

This map can be found on the District of Sechelt website.

- Direct link:
<https://gis.sechelt.ca/portal/apps/sites/#/webmaps/apps/023c8c0e34df42849bc5531e8439f0da/explore>
- Manual Navigation:
 1. Go to www.sechelt.ca
 2. Under the “living here” tab, select “maps”
 3. A new page will load; select “Sechelt Explorer” from the top bar (beside the logo)

Step 2 – locate your property

Once loaded, type your address into the search bar in the top left-hand corner

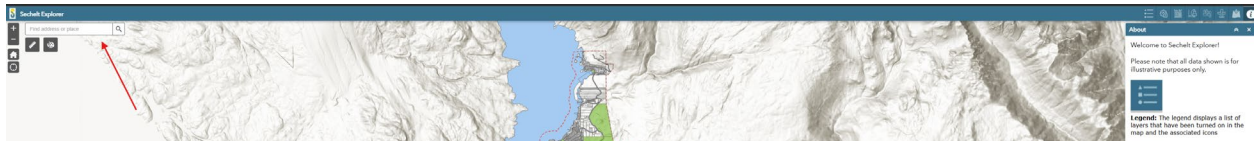

Step 3 – Turn on Zoning Layer

On the top right menu, select the map icon:



From the planning menu, select “Zoning Bylaw 580”:

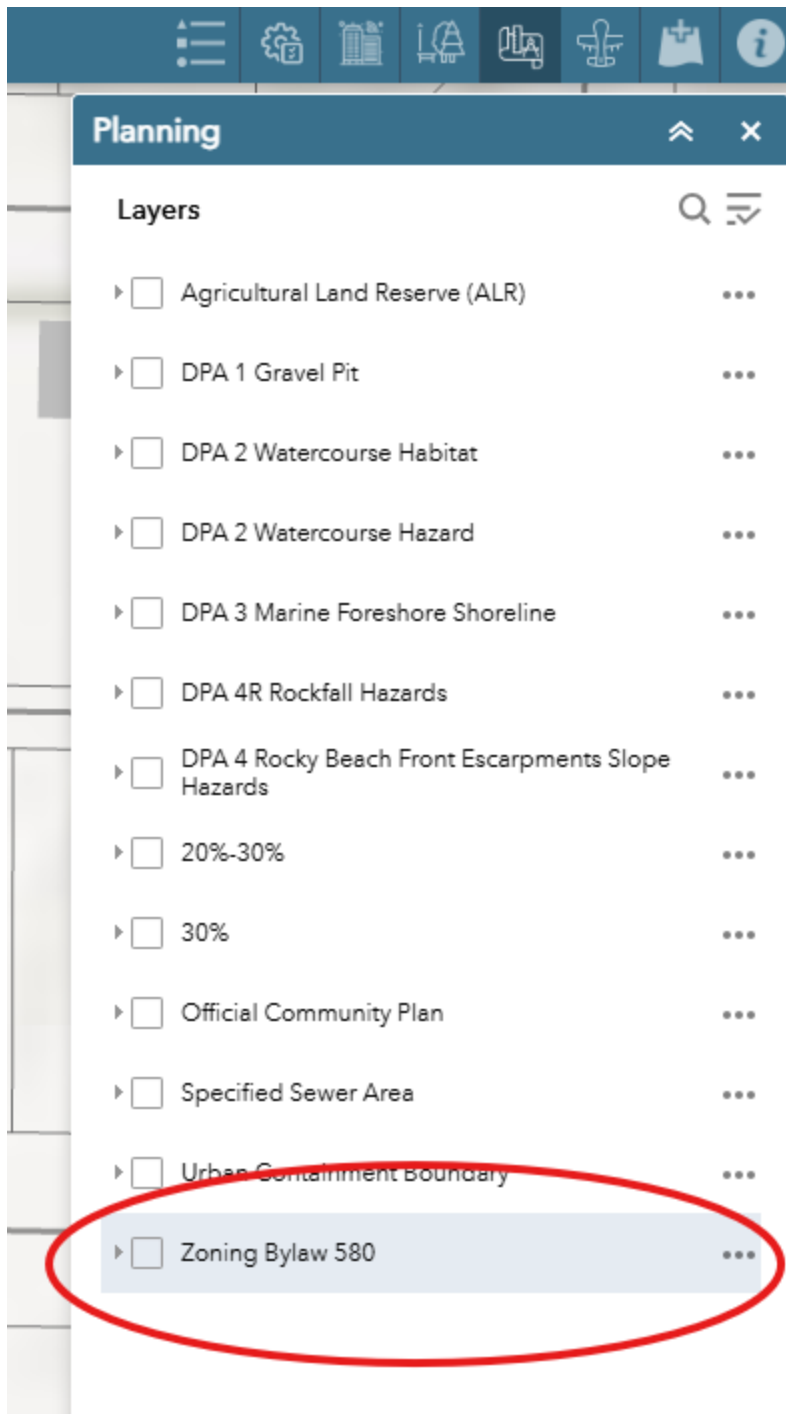

Once selected, the map should now show colour blocked sections, with the zone identified in white text (examples CC-1, C4 ect..)

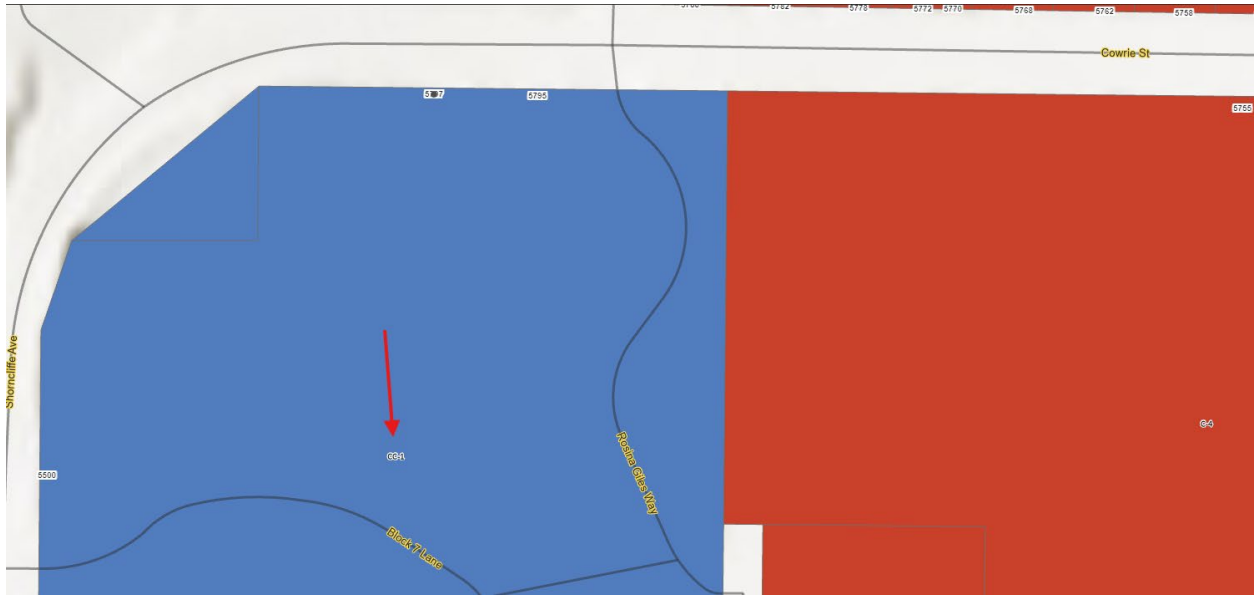

Now that you know your zoning, review our [Zoning Bylaw](#) and navigate to that zone in order to see zoning intent, permitted uses, density parameters and other regulations of your properties zone, or visit our zoning webpage at www.sechelt.ca/zoning